



Parks, Recreation
& Libraries

ANNUAL REPORT 2023

Everything we do
makes a healthier you!



DIRECTORS MESSAGE



Dear Roseville Community,

As we reflect on 2023, I am filled with pride and gratitude for the remarkable achievements and milestones we've reached together in Roseville Parks, Recreation & Libraries. This year has been a testament to our commitment to enhancing the quality of life for all residents through exceptional services, programs and spaces.

Our parks and recreation programs have continued to thrive, providing spaces for families to gather, children to play and individuals to engage in healthy activities. One notable highlight is the more than 200,000 participations in our Adventure Club before and after school programs, demonstrating the trust our community places in us to provide safe, enriching environments for our youth.

We were also excited to introduce new adaptive and sensory-friendly program options this year. These programs are designed to be inclusive and accessible, ensuring that everyone in our community has the opportunity to participate and enjoy our offerings.

Our libraries have also seen exciting developments. With more than 1.4 million items circulated and an increase in community engagement through diverse programs and events, our bond with the community is stronger than ever. Our libraries remain a vital hub for learning, inspiration and fostering connections.

The visibility of cultural arts was enhanced this year with several vibrant murals which promote creativity and nurture imagination. Additionally, we dedicated a new sculpture at Veterans Memorial Park North providing a meaningful space for reflection.

We were thrilled to welcome over 1.1 million visitors to our facilities and over 3.4 million visitors to our parks this year. These numbers demonstrate our vibrant community engagement and the value our residents place on our services and spaces.

Significant progress was made on several key projects, including breaking ground on our new regional soccer complex. This facility will not only serve our community with top-notch soccer amenities but will also attract numerous tournaments, bringing in visitors and boosting our local economy.

This year, we were honored to be named a National Gold Medal Finalist in the field of Park and Recreation Management for the second year in a row, even while moving into a larger population category. This recognition reflects our dedication to excellence and the hard work of our staff, volunteers and partners who make our vision a reality.

Looking ahead, we are excited to continue building on this momentum. We remain committed to providing outstanding services and creating spaces where our community can come together, thrive and enjoy all that Roseville has to offer.

Thank you for your continued support and involvement in our programs and initiatives. Together, we are creating community and making life better in Roseville.

Jill Geller

Director

Parks, Recreation & Libraries

MISSION, VALUES & VISION



Mission

To enhance lives and the community by providing exceptional experiences.



Values

Diversity & Inclusion · Learning · Excellence
Fun & Celebration · Integrity · Innovation
Teamwork · Respect · Safety · Sustainability



Vision

To be the leader in creating a healthy community through progressive, sustainable and memorable experiences.

BUDGET

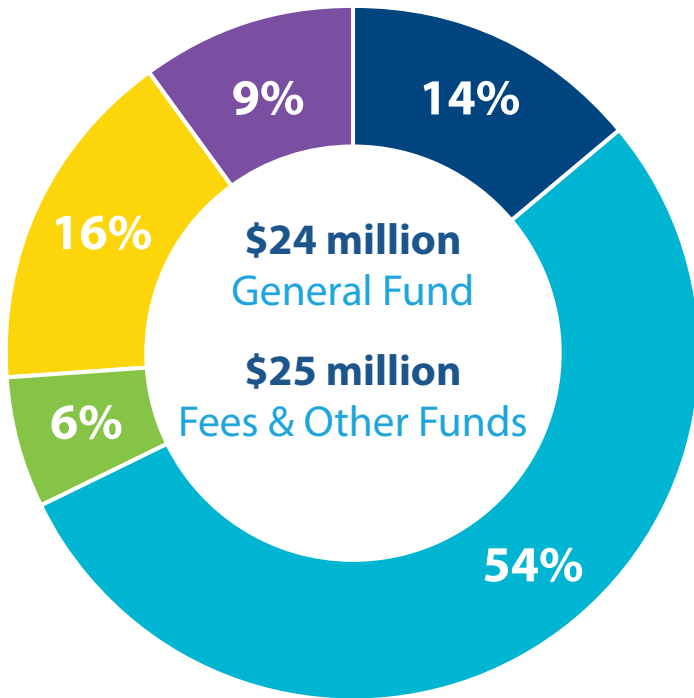

Where does funding come from?

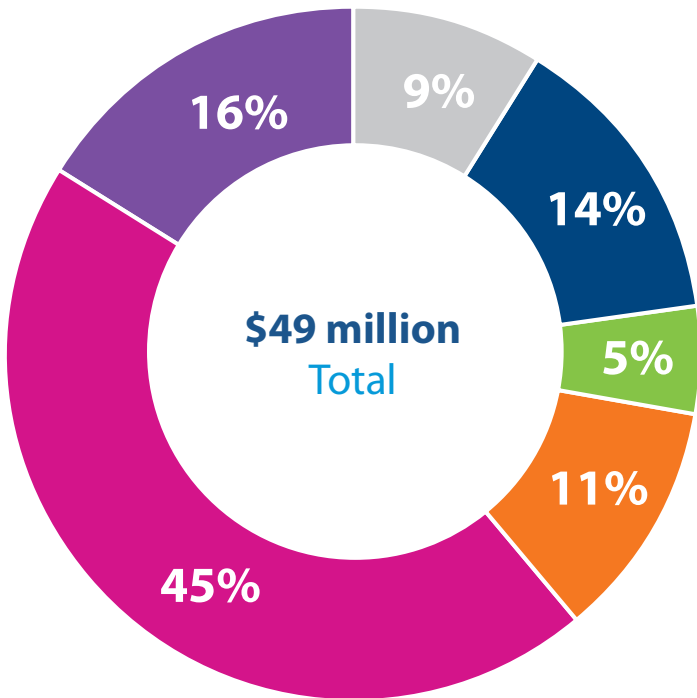

Where do we spend?



Fiscal Year 22/23

REGIONAL SOCCER COMPLEX IS A GAME-CHANGER!

The regional soccer complex is generating a buzz of anticipation and enthusiasm with residents. With its expansive 51-acre layout, featuring 10 state-of-the-art artificial turf fields, a universally accessible playground, ample parking, picnic areas, restrooms, concessions and even public art, this project is poised to become the ultimate hub for long-field sports and recreation in the area.

After the groundbreaking ceremony in June 2023, City Manager Dominick Casey expressed his pride, stating, "This new facility is a testament to the strong spirit of collaboration and the dedication of our community. The soccer complex will not only create a space for athletes to excel, but will also foster a sense of community and camaraderie. We look forward to the positive impact this facility will have on the lives of our residents and visitors."

Anticipated for completion in late 2025, this multipurpose facility provides a platform for a range of sports, including soccer, football, lacrosse and more. It's expected to accommodate local sports programs, promote sports tourism and entice regional sports leagues to choose Roseville as their destination of choice.

Parks Development Manager Tara Gee emphasizes the broader vision behind the project, stating, "We are not just building a soccer complex. We are building an experience that anyone who visits, whether they are from out of town or local, will want to come back for."

Beyond its recreational value, the soccer complex is also a catalyst for economic growth. By attracting out-of-town visitors, the facility will contribute to the City's General Fund through sales at retail and entertainment venues as well as restaurants and hotels, bolstering

our local economy and supporting ongoing community development. It will also redirect some of the impact at neighborhood parks to this new venue.

"The groundbreaking of the soccer complex marks a significant milestone for our community, symbolizing unity, vitality and a shared passion for sports," says Parks, Recreation & Libraries Director Jill Geller. "As we eagerly anticipate its completion, we can look forward to a future filled with thrilling athletic events, cherished memories and a stronger sense of togetherness among all residents of Roseville."

To stay informed about the project and see its progress, residents are encouraged to visit roseville.ca.us/parksintheworks and navigate to Regional Soccer Complex tab.

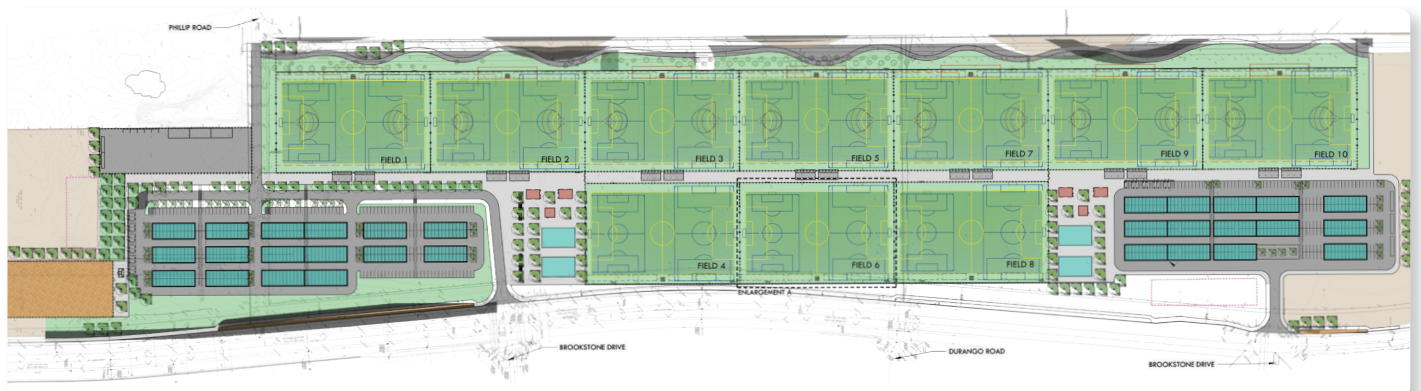

ATTENDANCE



56,386

**Vernon Street
Town Square &
Special Events**



79,979

Adult/Seniors
(FAB programs, sports
and enrichment)



89,994

Tot/Kid/Teen
(camps, sports,
enrichment and swim
lessons)



243,856

Childcare
(Adventure Club, ASES,
preschool)



103,943

Golf Courses
(rounds played)

PARK VISITORS



1,443,923

Citywide parks



572,311

Neighborhood parks



947,234

School parks

FACILITIES

Signature Facilities

Adventure Club

Located on all 21 Elementary School campuses in Roseville, Adventure Club facilities provide before and afterschool programs for school-aged children.

Aquatics

Aquatic programs, events and private rentals are offered at three pools across Roseville: Johnson Pool, Roseville Aquatics Complex and Mike Shellito Indoor Pool.

Mahany Fitness Center

The Mahany Fitness Center is both a fitness center and community center offering a cardio and weights room, group exercise and full size gym, TRX and fitness coaches.

Maidu Community Center

Located in Maidu Regional Park, Maidu Community Center is a hub for business and social rentals while also hosting a variety of recreation and fitness classes.

Diamond Oaks Golf Course

Serving the community since 1963, Diamond Oaks Golf Course is one of the greater Sacramento region's most popular facilities.

Woodcreek Golf Club

Designed by Robert Muir Graves in 1995, Woodcreek features a distinct mix of 18 championship holes set amongst mature oak trees and native wetland habitat.

Libraries

Roseville Public Library provides services at three convenient locations. The Downtown Library is just across the creek from Royer Park; the Maidu Library is located in Maidu Regional Park; and the Riley Library calls Mahany Park home.

Maidu Museum & Historic Site

The Maidu Museum & Historic Site showcases California Indian traditional practices, such as acorn processing and basket weaving and provides access to see hundreds of bedrock mortars, ancient petroglyphs and native plants/animals on the Historic Site.

Number of Visitors Annually

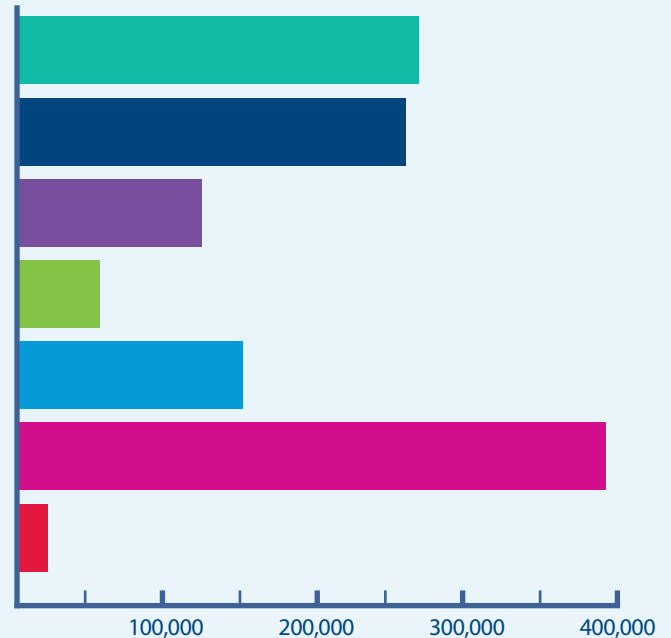

FINDING FITNESS AND COMMUNITY

Fitness is an important part of a healthy and active lifestyle. From our outdoor fitness court to our fitness center, parks and pools, Roseville provides plenty of ways for residents to stay active and get fit.

Kathy Youngs has lived in Roseville for more than 30 years and takes full advantage of the fitness options. She decided to improve her overall wellness and got a COR Fitness Membership, making a resolution that she would work out at least four times a week, "I have tried a bunch of different types of classes: Cycle Circuit, Aqua Yoga, Ball Yoga and so many more," says Kathy. "When I started I just wanted to hide in the corner, but everyone here is so welcoming. I love it."

Kathy visits the Mahany Fitness Center and Mike Shellito Indoor Pool and loves the sense of community and family that comes with it. "Everyone is so supportive and friendly," she says. "I've made a lot of friends. And, since joining I feel stronger and healthier."



To learn more about our COR Fitness Membership options and outdoor Maidu Fitness Court visit roseville.ca.us/fitness



In addition to the fitness center and pool, the city offers fitness equipment in many parks but the Maidu Fitness Court is one of the most notable. The court is located near the Maidu Community Center and is a great option for those who want to work out in the fresh air and sunshine. It features a variety of equipment, and self-guided exercise to get a full body workout. It is free and open to anyone in the community.

Rachel Stewart is an Education Specialist with the Adult Transition Program at Woodcreek High School. She and other Education Specialists regularly take their students out for 'Workout Wednesdays' and recently brought their classes together at the Maidu Fitness Court for a day of fun. "We build in fitness as part of the learning experience," says Rachel. "This is the most involved I've seen the students. You could see their excitement, every single one was engaged, not one grumbled."

Rachel adds, "Having this fitness court and our local parks and trails is a great way for our students to get outside, be active and to hang out with like adults in the community. It's so meaningful to watch them build relationships and grow together."

VOLUNTEERS

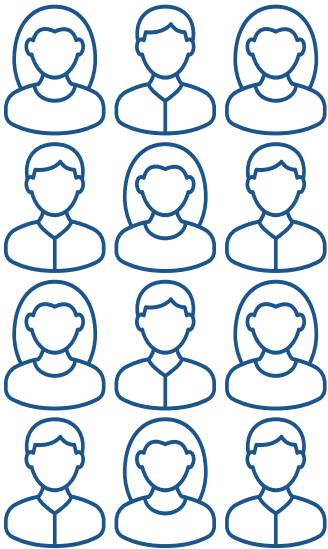

Volunteers are an essential part of Parks, Recreation & Libraries. Volunteers perform duties ranging from park maintenance projects to tree plantings to youth sports coaches to literacy/homework tutors to museum school tours and so much more. We could not do all that we do without the dedicated volunteer community of Roseville.

Total Volunteer Hours
8,219

Value
\$246,159

\$29.95 per hour based on the California hourly rate as determined by the Independent Sector for 2023.

RECREATION

Achievements

- Provided swim lessons to over 9,000 participants, while 1 pool was closed for 3 months.
- COR Fitness added a variety of fitness membership options, increasing memberships by 12%.
- Increased rental revenue at Maidu Community Center and Mahany Fitness Center by 12%, which totals over \$59k.
- Opened two new Adventure Club sites.
- Completed facility improvements at both Maidu Community Center and Mahany Fitness Center.
- Developed many new events including CommUNITY Picnic, Dinner On The Bridge, Cookies & Milk With Santa, Chalk Your Walk, Breakfast With The Bunny and Senior Prom.
- Created adaptive programming opportunities.
- Provided 248 swimsuits at Boutique Nights for underserved children through Operation Swim.
- Launched Junior Leader program at Adventure Club with 84 participants.
- Updated the PRL Scholarship Program, awarding \$36,800 in scholarships.



EMBRACING DIVERSITY AND INCLUSION AT OUR LIBRARIES



Our three Roseville libraries are much more than places to go to pick up your favorite book or get resources for a school project. These spaces go above and beyond to function as adaptive centers designed to meet the diverse needs of our community.

Inside, an extensive collection of books caters to all ages and abilities. In our Downtown Library is a well-attended ASL (American Sign Language) storytime that brings the magic of stories to life for children from the deaf community.

"It is a bilingual storytime that is also open to hearing families, which gives deaf and hearing children the opportunity to interact with each other once a week," says Librarian Lisa Eck. "This program allows them to have

a space to enjoy each other, the fun stories and for kids and families to feel like they are part of the community. It's just one of the many things we do here at the library to make our programs accessible for everyone."

Understanding diverse needs, the libraries partner with the California State Library by providing applications to the Braille and Talking Book Library. This service offers materials for all ages who are visually or physically impaired. The library offers a Dyslexic font for eBooks through their Libby app ensuring the titles can be enjoyed by many.

ADA-compliant computer accessories, including the Jumbo Switch and keyboards with large fonts, extend technological opportunities to

individuals with special needs. Librarian Sara Schlehofer encourages visitors to explore these resources, stating, "Library staff are available to assist with information and resources to support those with diverse disabilities. To further foster inclusivity, our libraries host inclusive programs for all ages and are working toward creating kits for those with sensory sensitivities."

Outside, our Martha Riley Library has a universally accessible playground which welcomes visitors, setting the tone for an all-inclusive environment.

Our Roseville Libraries embrace diversity and community, offering limitless opportunities for learning and innovation.

Learn more at roseville.ca.us/library or roseville.ca.us/adaptive

PARK DEVELOPMENT



Accomplishments:

- Dedicated three new parks: Four Corners Park, Audrey Huisling Park and Apollo Dog Park.
- Rehabbed nine play structures at Kenwood Oaks, Stephenson, Royer, Blue Oaks, Lockridge, Erven and White parks.
- Replastered the recreation pool, replaced the slide and installed a new spray ground at the Roseville Aquatics Complex.
- Replastered the Mike Shellito Indoor Pool.
- Began construction of the regional soccer complex.

LIBRARIES AND CULTURE



Achievements

- Introduced a new computer reservation and wifi printing system.
- Implemented new self-loan borrowing stations and enhanced the library catalog system.
- Experienced a 26% increase in visitors and 90% increase in program attendance.
- Launched the return of "Night Out At The Museum" at Maidu Museum & Historic Site.
- Installed three murals in PRL facilities.
- Added an art sculpture installation at Veterans

PARKS OPERATIONS

Park Operations is part of the Parks Division and is responsible for the maintenance and rehab of Roseville's 84 parks, 109 playgrounds, 355 acres of streetscapes, 216 acres of turf and sports fields, 3 aquatics facilities, 4 spray grounds, 42 ballfields, 58 soccer fields, 12 pickleball courts and 5 dog parks. In all, Park Operations is responsible for the care of 946 acres of parkland. Park Operations staff and contractors perform duties daily to provide our customers an exceptional experience by ensuring safe, clean, and well-maintained environments.

Achievements

- Maintained a 30% water reduction, which began as part of stage 2 drought conditions.
- Added maintenance of 3 new parks – Four Corners, Audrey Husking and Apollo Dog Park.
- Installed new playgrounds at Kenwood, Erven, Stephenson and White parks.
- Renovated historic Lincoln Estates cement slide.
- Replaced benches and picnic tables at Kenwood, Buljan, Santucci, Crestmont, Summerhill, Stephenson, Davis parks and Brown ballfields.
- Replaced two pool heaters at the Roseville Aquatics Complex.
- Installed fencing around Maidu Soccer Fields and outfield fencing at Central and Crabb parks.
- Conducted volunteer renovations projects at Mahan, Maidu, Vernon Street Town Square and Crestmont parks.
- Replaced synthetic turf on bocce courts at Festerson Park.
- Extended the pathway between fields 1 and 2 at Crestmont Park to improve ADA accessibility.
- Added new fence topper at Lockridge Park.
- Installed new park monument sign at Hillsborough Park.
- Restored the drinking fountain at Wallace Park at Cresthaven.



OPEN SPACE & URBAN FORESTRY

Open Space & Urban Forestry Teams, as part of the Parks Division, protect and conserve the City's natural resources and provide public use that reflects sound resource management and community values. Open Space maintains 4,000+ acres of preserves and open space land, 74 miles of creeks and riparian areas, 38+ miles of bike trails, over 5,000 oak mitigation trees and over 55,000 trees maintained in the City's Urban Forest. The Open Space team also participates in weekly unsheltered camp cleanup activities to help protect the environment.

Achievements

- Pruned more than 8,800 trees and planted over 3,500 trees in parks and open space.
- Acquired 325 acres of new open space.
- Removed 71 obstructions in creeks.
- Completed sign inventory on trails.
- Continued coordination with Roseville Police Department for unsheltered camp clean-up activities.
- Developed a new unsheltered tiered prioritization system and implemented a new mapping/tracking platform.
- Developed a designated Creek Crew and Unsheltered Response Team.
- Maintained 350+ acres of firebreaks and 15 acres of new firebreaks in the open space.
- Goats grazed 1,800 acres of open space.
- Removed 396 unsheltered camps with approximately 81 tons of debris.



Events

- Created inaugural Trail-a-bration event highlighting nine trails.
- Coordinated volunteer events including tree planting, mulch spreading, creek clean-ups, trash sweep at Creekview and the Fiddymont House property clean up.

